

# Part List T68, Standard

## by Toko (toko@gsm-free.org)

### Contents

<b>1</b>	<b>Mounting Drawings .....</b>	<b>2</b>
<b>2</b>	<b>Exploded View T68.....</b>	<b>3</b>
<b>3</b>	<b>Component List.....</b>	<b>4</b>
3.1	Mechanical Parts T68 .....	4
3.2	2/ROA 117 9732/1 .....	4
<b>4</b>	<b>Revision History .....</b>	<b>5</b>

# 1 1. Mounting Drawings

1078- the Mounting drawings show the components position on the printed board.  
The Mounting drawings can be found in document 1078-2/FEA 209 544/50.

Board Number	Mounting Drawing
2/ROA 117 9732/1 P2E	1078-2/ROA 117 9732/1 Rev. PA8

## 2 2. Exploded View T68

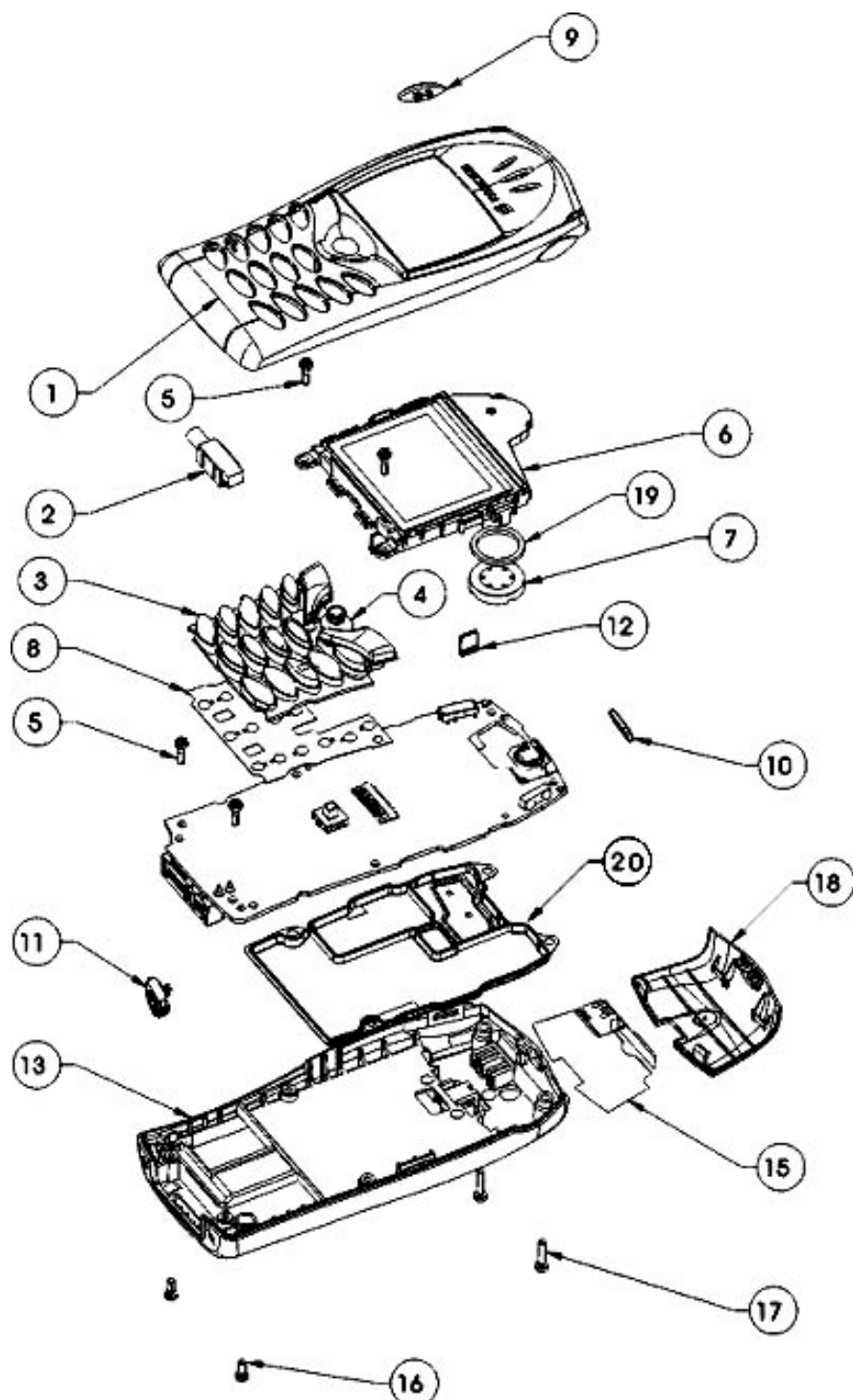

## 3. Component List

### 3.1 Mechanical Parts T68

- Contains mechanical parts.  
Pos. number refers to the Exploded View.  
Parts available to order will be found in the Web Shop.

Pos.	Description	Part Number	Comments
1	Front Assembly	SXK 107 9098	
	Front Assembly, co-branded	SXK 107 9098/5	Orange
	Front Assembly, co-branded	SXK 107 9098/6	AT&T
	Front Assembly, co-branded	SXK 107 9098/8	Voicestream
2	Vibrator Motor	BKE 902 019/5	
3	Keyboard	SXA 109 2241	
4	Button, Joystick	SXA 109 3230	
5	Screw/Frame	SXA 109 3155	
6	LCD	RNH 942 54	
7	Loudspeaker Assembly	RLE 908 05	
8	Dome Switch Foil	SXA 109 2223	
9	Volume Key	SXA 109 2226	
10	Gasket for Buzzer	SXA 109 3149	
11	Microphone Assembly	SXK 107 9582	
12	Conductive Elastomer	SXA 109 4285	
13	Frame Assembly	SXK 107 9095	
15	Antenna, Flex	KRE 105 95	
16	Screw, Front/Bottom	SXA 109 3952	
17	Screw, Front/Top	SXA 109 2232	
18	Antenna Cover Assy.	SXK 107 1234	
19	Speaker Gasket	SXA 109 3614	
20	Shielding Can	SXA 109 2227	

### 3.2 2/ROA 117 9732/1

- Contains only components that are possible to replace.  
Pos. number refers to the components position number on the board.  
Parts available to order will be found in the Web Shop.

2/ROA 117 9732/1			
Pos.	Description	Part Number	Comments
H600	Buzzer	KLJ 110 002	
H623	Lcd connector	SXA 109 2432	
J602	System connector	RNV 799 03	
S50	Joystick	SXA 109 2476	
S820	Volume Switch	RMF 899 09	

## 3 4. Revision History

Rev.	Date	Changes / Comments
PA1	2001-06-18	
PA2	2001-07-17	Pos. 12, Conductive Elastomer added
A	2001-10-17	Exploded view added
B	2002-02-22	W001 Antenna Switch RPT 799 08 not available as part
C	2002-05-06	Pos. 20, shielding can added. Pos 1, co-branded fronts added
D	2002-08-05	Volume Switch added